

# Distinctive Shaker, Mission & Manchester Style Living Room Furniture



Solid Oak, Maple & Cherry • Living Room Furniture  
ENTERTAINMENT CENTERS • TV STANDS • END TABLES • HALL TABLES • COFFEE TABLES



# 2014 New Items ▶▶

We have expanded our line in 2014 to include several new items.



**Man5233B-2D ▶ Corner Television Stand**  
52"w x 33"h x 18"d  
One Adjustable Shelf Behind Doors • One Drawer on Bottom  
*Shown in Maple with Onyx Stain*



**Man4633B-2D ▶ Television Stand**  
46"w x 33"h x 18"d  
One Adjustable Shelf Behind Doors • Two Drawers on Bottom

**Man4646H ▶ Hutch**  
47.5"w x 46"h x 11.75"d • With One Shelf  
*Both Shown in Maple with Onyx Stain*

Hutch  
has  
46" Wide  
TV  
Opening



**Man7633-4D ▶ Television Stand**  
76"w x 33"h x 18"d • Two Adjustable Shelves Behind Doors

**Man7646H ▶ Hutch**  
77.5"w x 46"h x 11.75"d  
With One Shelf and 2 Doors, Three Shelves Behind Doors  
*Both Shown in Maple with Onyx Stain*



**S7625-4D ▶ Television Stand**  
76"w x 25"h x 18"d • One Adjustable Shelf Behind Doors  
*Shown in Oak with Harvest Stain*





### Entertainment Center

Available with center units 46" to 86" wide

Shown with:

#### **S5633B-3D ▶ Television Stand**

56"w x 33"h x 18"d

Two Drawers on Bottom, Two Adjustable Shelves Behind Doors

#### **S2472T ▶ Tower**

24.25"w x 72"h x 18.625"d

With Two Shelves and 1 Door,

Two Shelves Behind Bottom Doors

*Shown in Oak with Harvest Stain*



#### **S6633B-3D ▶ Television Stand**

66"w x 33"h x 18"d • Two Adjustable Shelves Behind Doors

#### **S6646H ▶ Hutch**

67.5"w x 46"h x 11.75"d

With One Shelf

*Both Shown in Oak with Harvest Stain*



#### **S4433B-2D ▶ Corner Television Stand**

44"w x 33"h x 18"d

One Drawer on Bottom, One Adjustable Shelf Behind Doors

*Shown in Maple with Mission Maple Stain*



#### **M3633B-2D ▶ Television Stand**

36"w x 33"h x 18"d

One Drawer on Bottom, One Adjustable Shelf Behind Doors

*Shown in Oak with Harvest Stain*



#### **M5633C ▶ Television Stand**

56"w x 33"h x 18"d

Six Drawers, One Door, Three Adjustable Shelves Behind Door

#### **M5646H ▶ Hutch**

57.5"w x 46"h x 11.75"d • With One Shelf

*Both Shown in Oak with Harvest Stain*

# Shaker Furniture ▶▶

Our line of Shaker furniture features simple lines and wood Shaker knobs.

An assortment of stain options is available.

Combine stains for a unique two-tone finish.  
(See page 23)

Many custom options to choose from including:

- Choice of hardware (See page 22)
- Wood or glass doors
- Optional pull-out media trays



**S5633A-3D ▶ Television Stand**  
56"w x 33"h x 18"d  
One Adjustable Shelf Behind Doors  
*Shown in Maple with Rich Cherry Stain*



**S4433B-2D ▶ 44"w x 33"h x 18"d**  
One Drawer on Bottom, One Adjustable Shelf Behind Doors  
*Shown in Oak with Mission Maple Stain*



**S4433A-2D ▶ 44"w x 33"h x 18"d**  
6" DVD Opening • One Adjustable Shelf Behind Doors  
*Shown in Tiger Maple with Harvest Stain*

Choose  
Tiger  
Maple for  
a Unique  
Look



Grain Detail





### Entertainment Center

Available with center units 46" to 86" wide

Shown with:

#### **S5633B-3D ▶ Television Stand**

56"w x 33"h x 18"d

Two Drawers on Bottom, Two Adjustable Shelves Behind Doors

#### **S2472T ▶ Tower**

24.25"w x 72"h x 18.625"d

With Two Adjustable Shelves Behind Wood Door on Bottom,

Two Adjustable Shelves Behind Glass Door on Top

*Shown in Oak with Harvest Stain*



#### **S6633-3D ▶ Television Stand**

66"w x 33"h x 18"d • Two Adjustable Shelves Behind Doors

#### **S6646H ▶ Hutch**

67.5"w x 46"h x 11.75"d • With One Shelf

*Both Shown in Oak with Harvest Stain*



#### **S4633A-3D ▶ Television Stand**

46"w x 33"h x 18"d

One Adjustable Shelf Behind Doors

Note: Shelves holding media storage trays are adjustable.

*Shown in Oak with Harvest Stain*



Two-tone  
Finish  
Black  
Paint with  
Harvest  
Rub  
Through

#### **S4633A-3D ▶ Television Stand**

46"w x 33"h x 18"d

One Adjustable Shelf Behind Doors

*Shown in Oak with Harvest Stain*



#### **S4633A-2D ▶ Television Stand**

46"w x 33"h x 18"d

One Adjustable Shelf Behind Doors

*Shown in Oak with S-2 Stain*

# Shaker Furniture ► Television Stands

## 36" Wide TV Stands

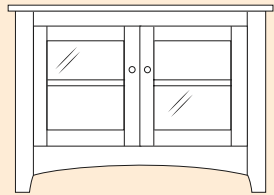

**S3625-2D** ► 36"w x 25"h x 18"d  
One Adjustable Shelf Behind Doors

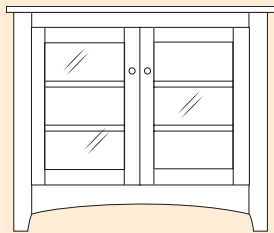

**S3633-2D** ► 36"w x 33"h x 18"d  
Two Adjustable Shelves Behind Doors

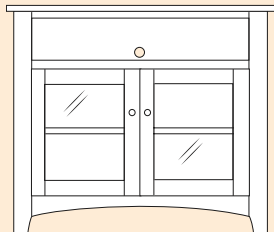

**S3633A-2D** ► 36"w x 33"h x 18"d  
6" DVD Opening • One Adjustable Shelf Behind Doors

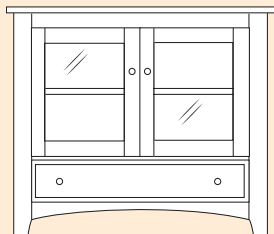

**S3633B-2D** ► 36"w x 33"h x 18"d  
One Drawer on Bottom • One Adjustable Shelf Behind Doors

## 46" Wide TV Stands - 2 Door

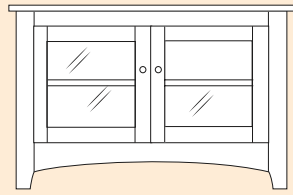

**S4625-2D** ► 46"w x 25"h x 18"d  
One Adjustable Shelf Behind Doors

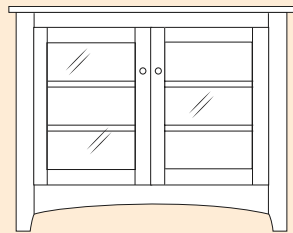

**S4633-2D** ► 46"w x 33"h x 18"d  
Two Adjustable Shelves Behind Doors

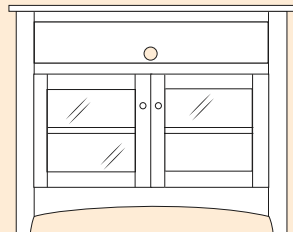

**S4633A-2D** ► 46"w x 33"h x 18"d  
6" DVD Opening • One Adjustable Shelf Behind Doors

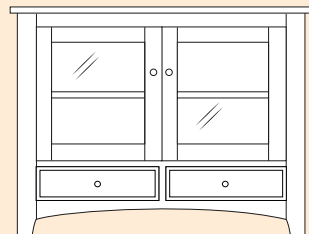

**S4633B-2D** ► 46"w x 33"h x 18"d  
Two Drawers on Bottom • One Adjustable Shelf Behind Doors

## 46" Wide TV Stands - 3 Door



**S4625-3D** ► 46"w x 25"h x 18"d  
One Adjustable Shelf Behind Doors

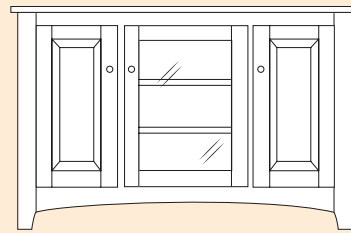

**S4633-3D** ► 46"w x 33"h x 18"d  
Two Adjustable Shelves Behind Doors

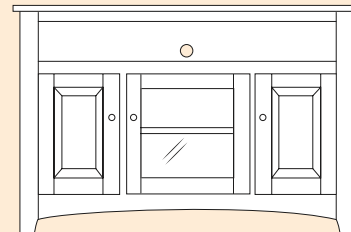

**S4633A-3D** ► 46"w x 33"h x 18"d  
6" DVD Opening • One Adjustable Shelf Behind Doors

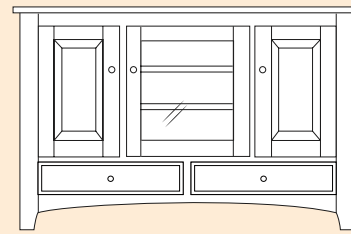

**S4633B-3D** ► 46"w x 33"h x 18"d  
Two Drawers on Bottom  
Two Adjustable Shelves Behind Center Door  
One Adjustable Shelf Behind Side Doors

## 56" Wide TV Stands

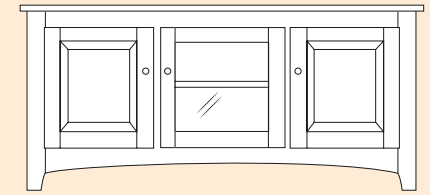

**S5625-3D** ► 56"w x 25"h x 18"d  
One Adjustable Shelf Behind Doors

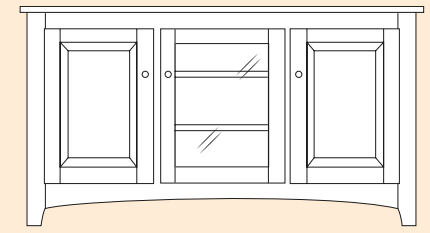

**S5633-3D** ► 56"w x 33"h x 18"d  
Two Adjustable Shelves Behind Doors

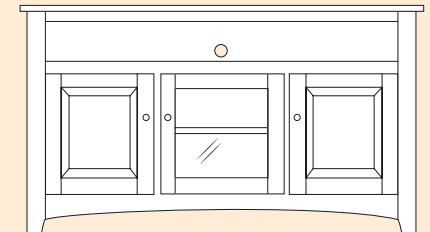

**S5633A-3D** ► 56"w x 33"h x 18"d  
6" DVD Opening • One Adjustable Shelf Behind Doors

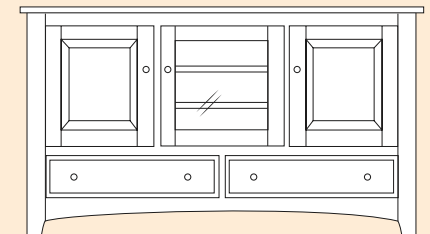

**S5633B-3D** ► 56"w x 33"h x 18"d  
Two Drawers on Bottom  
Two Adjustable Shelves Behind Center Door  
One Adjustable Shelf Behind Side Doors

# Shaker Furniture ▶ Television Stands

## 66" Wide TV Stands

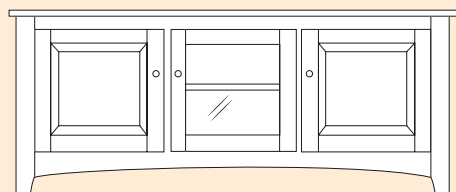

**S6625-3D** ▶ 66"w x 25"h x 18"d  
One Adjustable Shelf Behind Doors

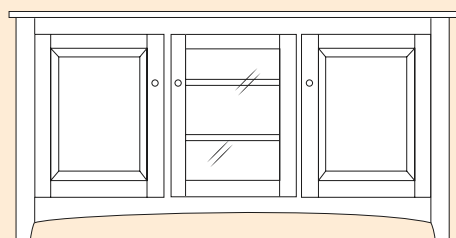

**S6633-3D** ▶ 66"w x 33"h x 18"d  
Two Adjustable Shelves Behind Doors

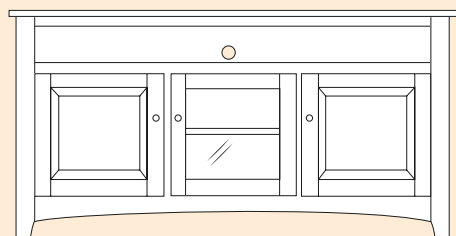

**S6633A-3D** ▶ 66"w x 33"h x 18"d  
6" DVD Opening • One Adjustable Shelf Behind Doors

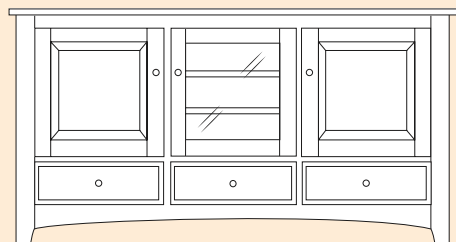

**S6633B-3D** ▶ 66"w x 33"h x 18"d  
Three Drawers on Bottom  
Two Adjustable Shelves Behind Center Door  
One Adjustable Shelf Behind Side Doors

## 76" Wide TV Stands

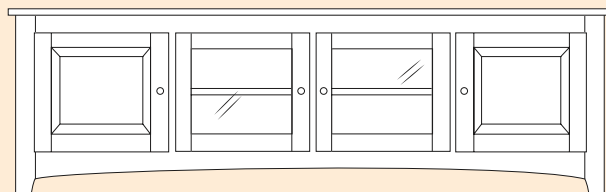

**S7625-4D** ▶ 76"w x 25"h x 18"d  
One Adjustable Shelf Behind Doors

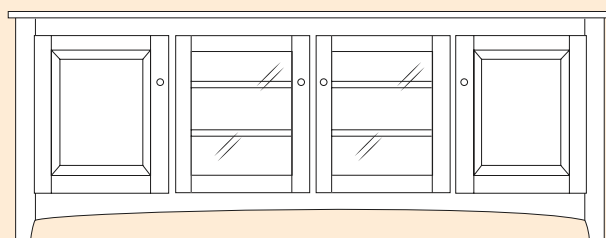

**S7633-4D** ▶ 76"w x 33"h x 18"d  
Two Adjustable Shelves Behind Doors

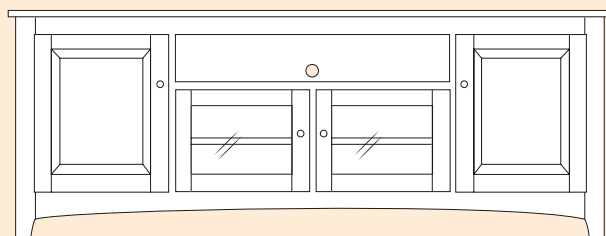

**S7633A-4D** ▶ 76"w x 33"h x 18"d  
6" DVD Opening • One Adjustable Shelf Behind Center Doors  
Two Adjustable Shelves Behind Side Doors

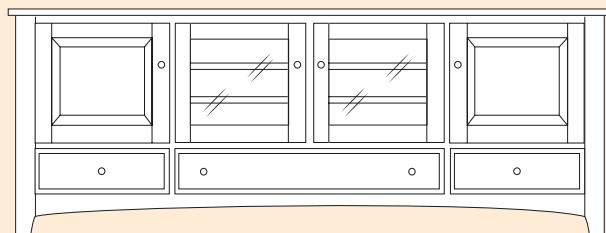

**S7633B-4D** ▶ 76"w x 33"h x 18"d  
Three Drawers on Bottom  
Two Adjustable Shelves Behind Center Doors  
One Adjustable Shelf Behind Side Doors

# ▶ Hutches

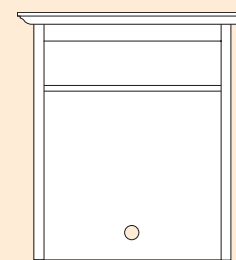

**S3646H** ▶ 37.5"w x 46"h x 11.75"d  
With One Shelf

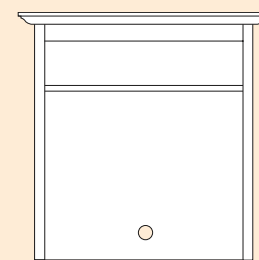

**S4646H** ▶ 47.5"w x 46"h x 11.75"d  
With One Shelf

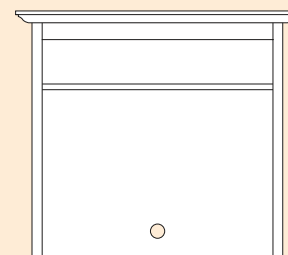

**S5646H** ▶ 57.5"w x 46"h x 11.75"d  
With One Shelf

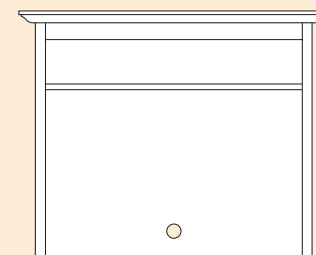

**S6646H** ▶ 67.5"w x 46"h x 11.75"d  
With One Shelf

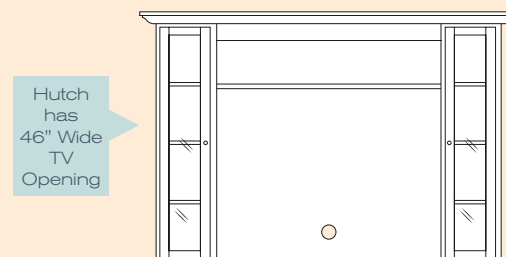

**S7646H** ▶ 77.5"w x 46"h x 11.75"d  
With One Shelf and 2 Doors • Three Shelves Behind Doors

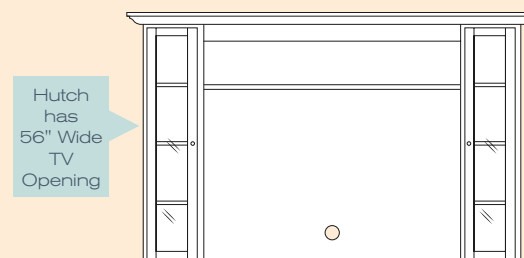

**S8646H** ▶ 87.5"w x 46"h x 11.75"d  
With One Shelf and 2 Doors • Three Shelves Behind Doors

# Shaker Furniture

## ► Entertainment Center

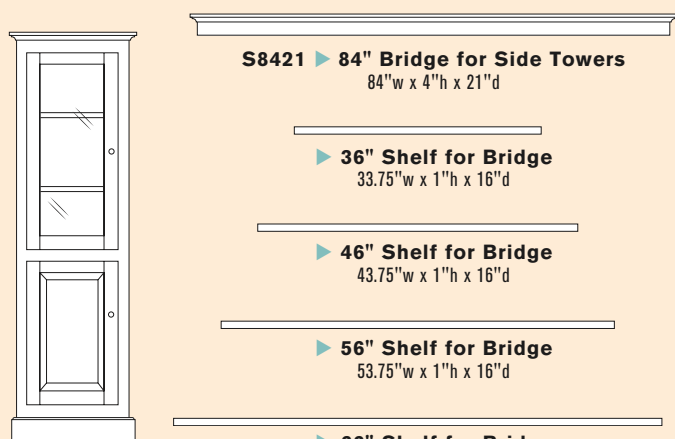
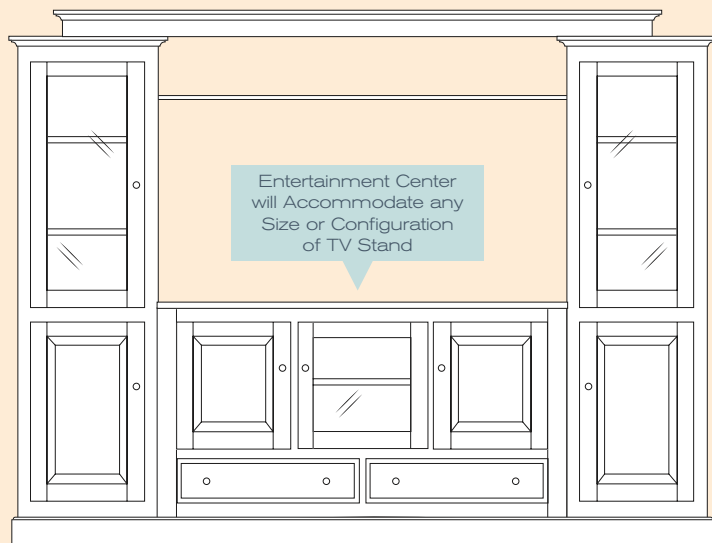

**S2464T ► 64" Tower**  
24.25"w x 64"h x 18.625"d  
One Adjustable Shelf Behind Wood Door on Bottom, Two Adjustable Shelves Behind Glass Door on Top

**S2472T ► 72" Tower**  
24.25"w x 72"h x 18.625"d  
Two Adjustable Shelves Behind Wood Door on Bottom, Two Adjustable Shelves Behind Glass Door on Top

### Dimensions for Corner TV Stands

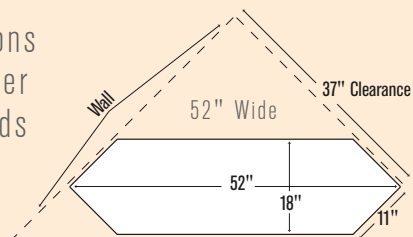
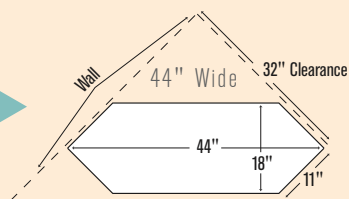

## ► Corner Television Stands

### 44" Wide Corner TV Stands

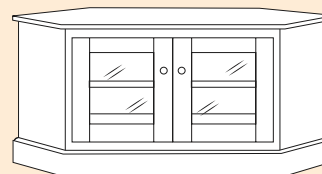

**S4425-2D ► 44"w x 25"h x 18"d**  
One Adjustable Shelf Behind Doors

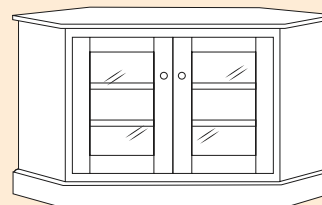

**S4433-2D ► 44"w x 33"h x 18"d**  
Two Adjustable Shelves Behind Doors

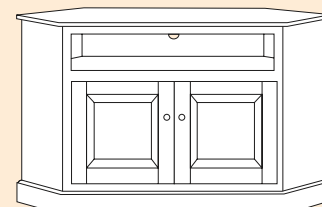

**S4433A-2D ► 44"w x 33"h x 18"d**  
6" DVD Opening • One Adjustable Shelf Behind Doors

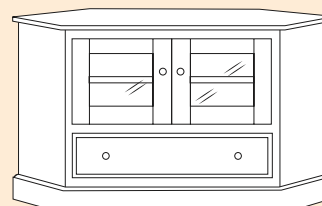

**S4433B-2D ► 44"w x 33"h x 18"d**  
One Drawer on Bottom  
One Adjustable Shelf Behind Doors

### 52" Wide Corner TV Stands

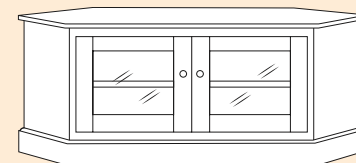

**S5225-2D ► 52"w x 25"h x 18"d**  
One Adjustable Shelf Behind Doors

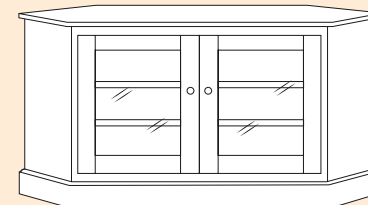

**S5233-2D ► 52"w x 33"h x 18"d**  
Two Adjustable Shelves Behind Doors

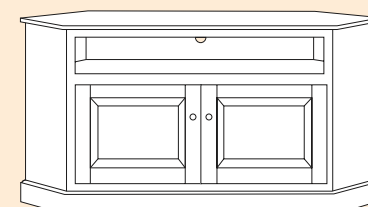

**S5233A-2D ► 52"w x 33"h x 18"d**  
6" DVD Opening • One Adjustable Shelf Behind Doors

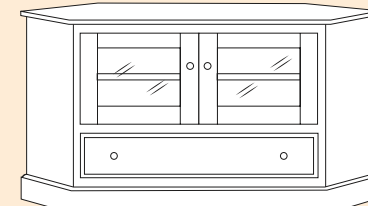

**S5233B-2D ► 52"w x 33"h x 18"d**  
One Drawer on Bottom  
One Adjustable Shelf Behind Doors



## ► Stereo Cabinets

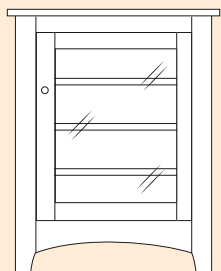

**S2533** ► 25"w x 33"h x 18"d  
Three Adjustable Shelves

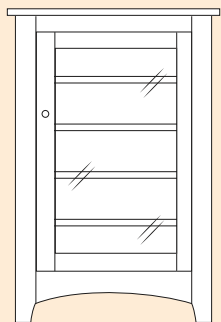

**S2540** ► 25"w x 40"h x 18"d  
Four Adjustable Shelves

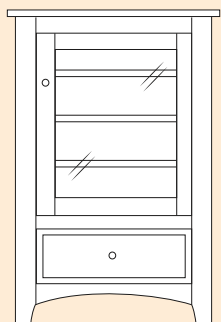

**S2540B** ► 25"w x 40"h x 18"d  
Three Adjustable Shelves and One Drawer

## ► Occasional Furniture



**S103WS** ► Coffee Table  
46"w x 18"h x 22"d  
With Shelf and Drawer



**S3** ► Coffee Table  
46"w x 18"h x 22"d



**S108** ► Writing Computer Desk  
36"w x 30"h x 18"d  
With Keyboard Drawer



**S104WS** ► End Table  
22"w x 25"h x 22"d  
With Shelf and Drawer



**S4** ► End Table  
20"w x 25"h x 22"d



**S105WS** ► Chairside Table  
17"w x 25"h x 22"d  
With Shelf and Drawer



**S5** ► Chairside End Table  
15"w x 25"h x 22"d



**S106WS** ► Hall Table  
36"w x 30"h x 15"d  
With Shelf and Drawer



**S6** ► Hall Console  
36"w x 30"h x 14"d



**S107WS** ► Sofa Table  
46"w x 30"h x 15"d  
With Shelf and Drawer



**S11** ► Microwave Stand  
30"w x 36"h x 18"d



**S13** ► Pie Safe  
36"w x 47"h x 16"d



**S12** ► Jelly Cupboard  
20"w x 47"h x 16"d



**S1** ► Trash Bin  
20"w x 30"h x 14"d



**S2** ► Trash Bin  
20"w x 34"h x 14"d  
With Drawer



# Mission Furniture ▶▶

Our line of Mission furniture features simple lines and black mission hardware.

An assortment of stain options is available.

Combine stains for a unique two-tone finish.  
(See page 23)

Many custom options to choose from including:

- Choice of hardware  
(See page 22)
- Wood or glass doors
- Optional pull-out media trays



**M107WS ▶ Sofa Table**  
46"w x 30"h x 15"d  
With Shelf and Drawer  
*Shown in Oak with Harvest Stain*



**M103WS ▶ Coffee Table**  
46"w x 18"h x 22"d  
With Shelf and Drawer  
*Shown in Oak with Harvest Stain*



**M104WS ▶ End Table**  
22"w x 25"h x 22"d  
With Shelf and Drawer  
*Shown in Oak with Harvest Stain*



**M6633-3D ▶ Television Stand**  
66"w x 33"h x 18"d  
Two Adjustable Shelves Behind Doors  
*Shown in Oak with Harvest Stain*



**M3633B-2D ▶ Television Stand**  
36"w x 33"h x 18"d  
One Drawer on Bottom • One Adjustable Shelf Behind Doors  
*Shown in Oak with Harvest Stain*



**M4633-2D ▶ Television Stand**  
46"w x 33"h x 18"d  
Two Adjustable Shelves Behind Doors  
*Shown in Oak with Harvest Stain*



**M4633A-2D ▶ Television Stand**  
46"w x 33"h x 18"d  
6" DVD Opening • One Adjustable Shelf Behind Doors  
*Shown in Oak with Harvest Stain*



**M4433A-2D ▶ Corner Television Stand**  
44"w x 33"h x 18"d  
6" DVD Opening • One Adjustable Shelf Behind Doors  
*Shown in Oak with Harvest Stain*



**M5225-2D ▶ Corner Television Stand**  
52"w x 25"h x 18"d  
One Adjustable Shelf Behind Doors  
*Shown in Oak with Harvest Stain*



# Mission Furniture ▶ Television Stands

## 36" Wide TV Stands

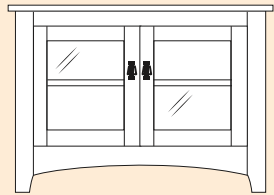

**M3625-2D** ▶ 36"w x 25"h x 18"d  
One Adjustable Shelf Behind Doors

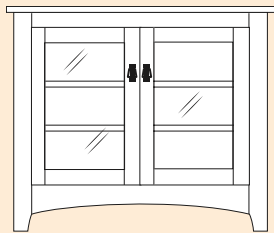

**M3633-2D** ▶ 36"w x 33"h x 18"d  
Two Adjustable Shelves Behind Doors

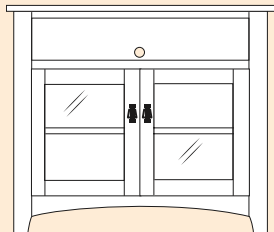

**M3633A-2D** ▶ 36"w x 33"h x 18"d  
6" DVD Opening • One Adjustable Shelf Behind Doors

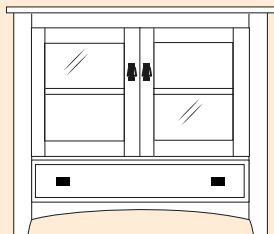

**M3633B-2D** ▶ 36"w x 33"h x 18"d  
One Drawer on Bottom • One Adjustable Shelf Behind Doors

## 46" Wide TV Stands - 2 Door

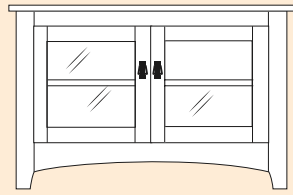

**M4625-2D** ▶ 46"w x 25"h x 18"d  
One Adjustable Shelf Behind Doors

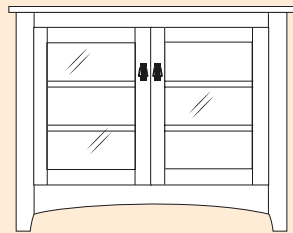

**M4633-2D** ▶ 46"w x 33"h x 18"d  
Two Adjustable Shelves Behind Doors

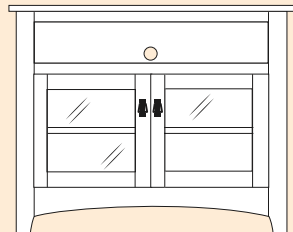

**M4633A-2D** ▶ 46"w x 33"h x 18"d  
6" DVD Opening • One Adjustable Shelf Behind Doors

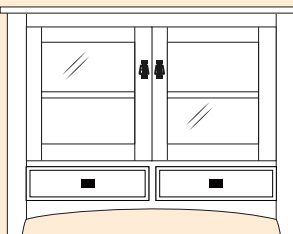

**M4633B-2D** ▶ 46"w x 33"h x 18"d  
Two Drawers on Bottom • One Adjustable Shelf Behind Doors

## 46" Wide TV Stands - 3 Door

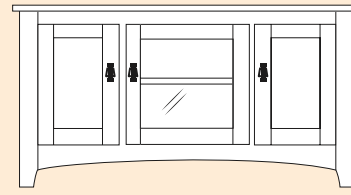

**M4625-3D** ▶ 46"w x 25"h x 18"d  
One Adjustable Shelf Behind Doors

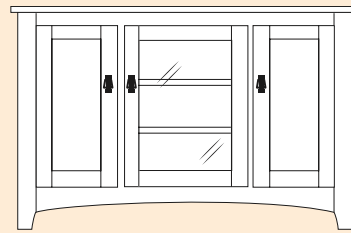

**M4633-3D** ▶ 46"w x 33"h x 18"d  
Two Adjustable Shelves Behind Doors

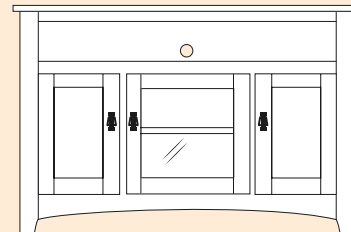

**M4633A-3D** ▶ 46"w x 33"h x 18"d  
6" DVD Opening • One Adjustable Shelf Behind Doors

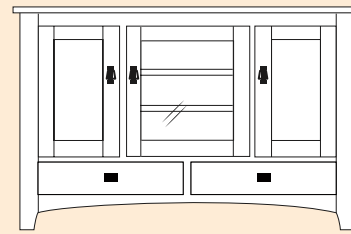

**M4633B-3D** ▶ 46"w x 33"h x 18"d  
Two Drawers on Bottom  
Two Adjustable Shelves Behind Center Door  
One Adjustable Shelf Behind Side Doors

## 56" Wide TV Stands

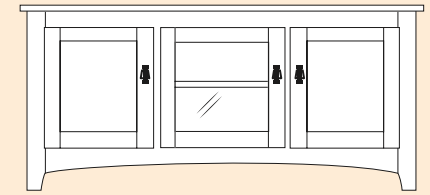

**M5625-3D** ▶ 56"w x 25"h x 18"d  
One Adjustable Shelf Behind Doors

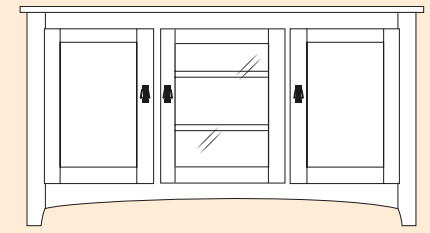

**M5633-3D** ▶ 56"w x 33"h x 18"d  
Two Adjustable Shelves Behind Doors

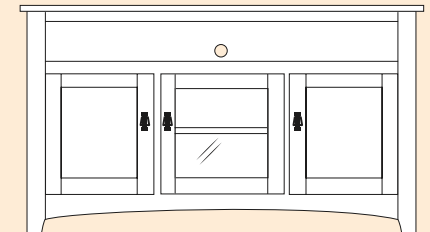

**M5633A-3D** ▶ 56"w x 33"h x 18"d  
6" DVD Opening • One Adjustable Shelf Behind Doors

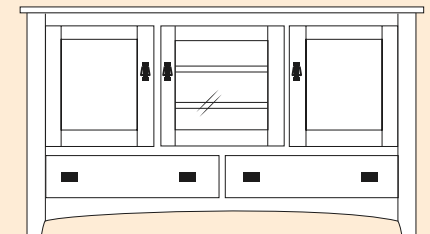

**M5633B-3D** ▶ 56"w x 33"h x 18"d  
Two Drawers on Bottom  
Two Adjustable Shelves Behind Center Door  
One Adjustable Shelf Behind Side Doors

# Mission Furniture ▶ Television Stands

## 66" Wide TV Stands

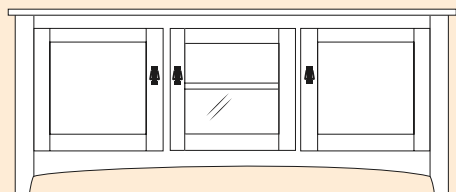

**M6625-3D** ▶ 66"w x 25"h x 18"d  
One Adjustable Shelf Behind Doors

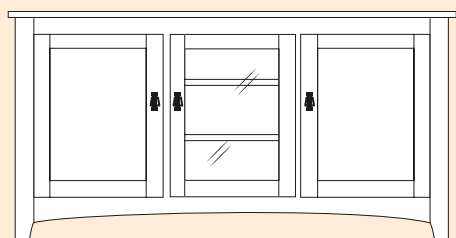

**M6633-3D** ▶ 66"w x 33"h x 18"d  
Two Adjustable Shelves Behind Doors

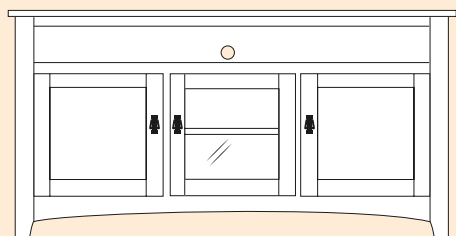

**M6633A-3D** ▶ 66"w x 33"h x 18"d  
6" DVD Opening • One Adjustable Shelf Behind Doors

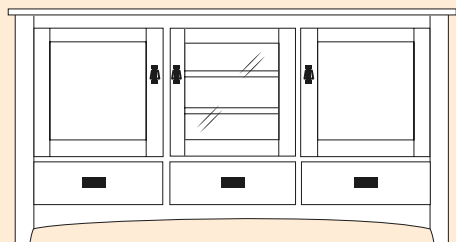

**M6633B-3D** ▶ 66"w x 33"h x 18"d  
Three Drawers on Bottom  
Two Adjustable Shelves Behind Center Door  
One Adjustable Shelf Behind Side Doors

## 76" Wide TV Stand

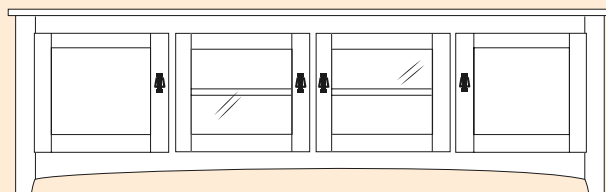

**M7625-4D** ▶ 76"w x 25"h x 18"d  
One Adjustable Shelf Behind Doors

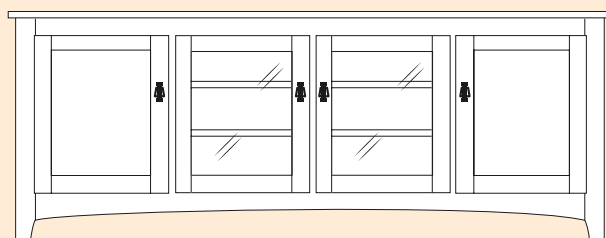

**M7633-4D** ▶ 76"w x 33"h x 18"d  
Two Adjustable Shelves Behind Doors

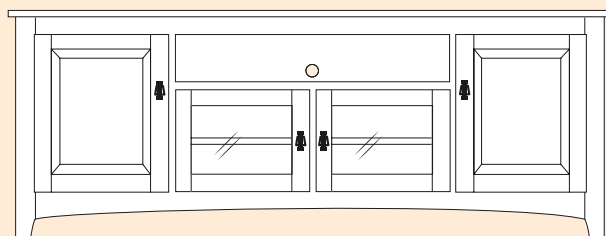

**M7633A-4D** ▶ 76"w x 33"h x 18"d  
6" DVD Opening • One Adjustable Shelf Behind Center Doors  
Two Adjustable Shelves Behind Side Doors

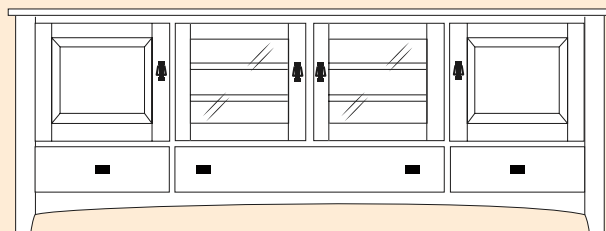

**M7633B-4D** ▶ 76"w x 33"h x 18"d  
Three Drawers on Bottom  
Two Adjustable Shelves Behind Center Doors  
One Adjustable Shelf Behind Side Doors

# ▶ Hutches

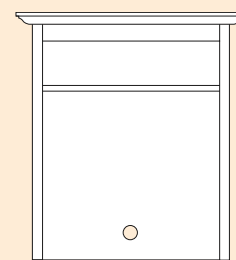

**M3646H** ▶ 37.5"w x 46"h x 11.75"d  
With One Shelf

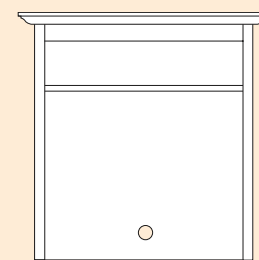

**M4646H** ▶ 47.5"w x 46"h x 11.75"d  
With One Shelf

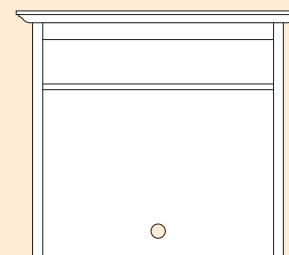

**M5646H** ▶ 57.5"w x 46"h x 11.75"d  
With One Shelf

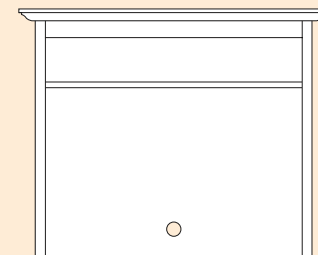

**M6646H** ▶ 67.5"w x 46"h x 11.75"d  
With One Shelf

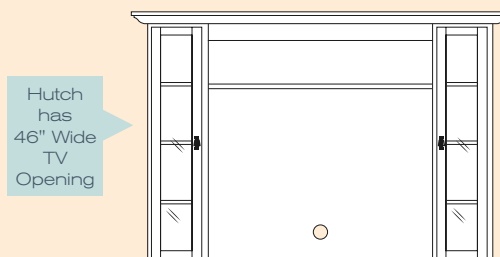

**M7646H** ▶ 77.5"w x 46"h x 11.75"d  
With One Shelf and 2 Doors • Three Shelves Behind Doors

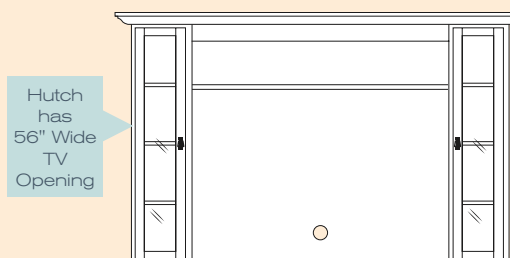

**M8646H** ▶ 87.5"w x 46"h x 11.75"d  
With One Shelf and 2 Doors • Three Shelves Behind Doors

# Mission Furniture

## ► Entertainment Center

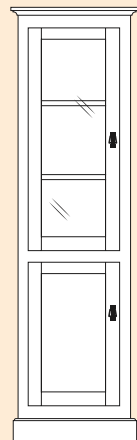
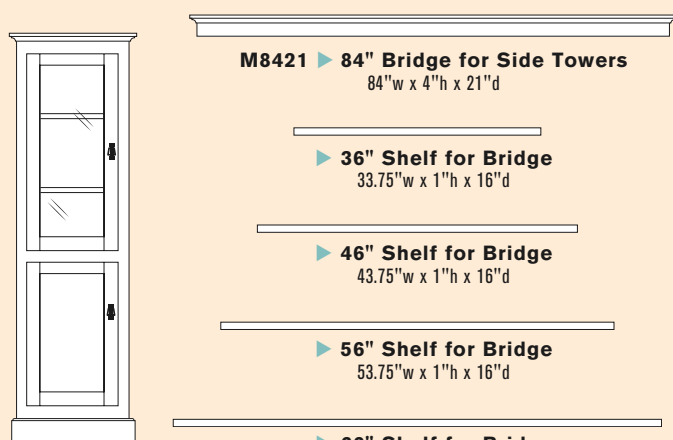
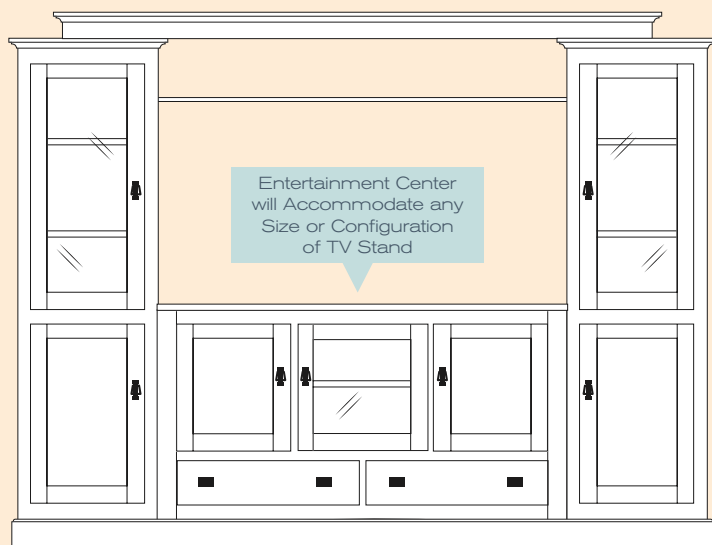

**M2464T ► 64\" Tower**  
24.25\"w x 64\"h x 18.625\"d  
One Adjustable Shelf Behind Wood Door on Bottom, Two Adjustable Shelves Behind Glass Door on Top

**M2472T ► 72\" Tower**  
24.25\"w x 72\"h x 18.625\"d  
Two Adjustable Shelves Behind Wood Door on Bottom, Two Adjustable Shelves Behind Glass Door on Top

### Dimensions for Corner TV Stands

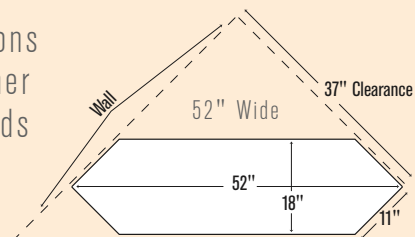
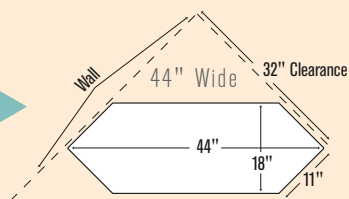

## ► Corner Television Stands

### 44\" Wide Corner TV Stands

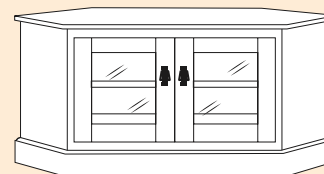

**M4425-2D ► 44\"w x 25\"h x 18\"d**  
One Adjustable Shelf Behind Doors

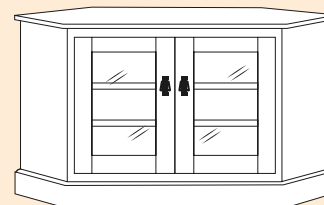

**M4433-2D ► 44\"w x 33\"h x 18\"d**  
Two Adjustable Shelves Behind Doors

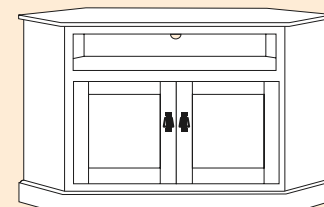

**M4433A-2D ► 44\"w x 33\"h x 18\"d**  
6\" DVD Opening • One Adjustable Shelf Behind Doors

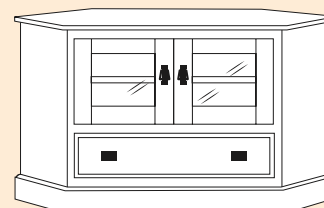

**M4433B-2D ► 44\"w x 33\"h x 18\"d**  
One Drawer on Bottom  
One Adjustable Shelf Behind Doors

### 52\" Wide Corner TV Stands

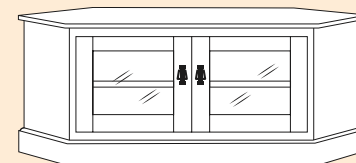

**M5225-2D ► 52\"w x 25\"h x 18\"d**  
One Adjustable Shelf Behind Doors

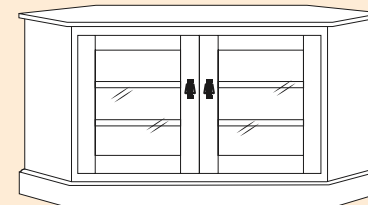

**M5233-2D ► 52\"w x 33\"h x 18\"d**  
Two Adjustable Shelves Behind Doors

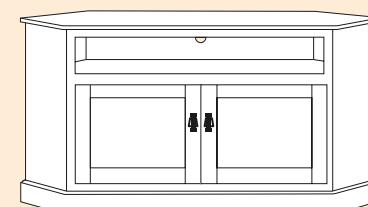

**M5233A-2D ► 52\"w x 33\"h x 18\"d**  
6\" DVD Opening • One Adjustable Shelf Behind Doors

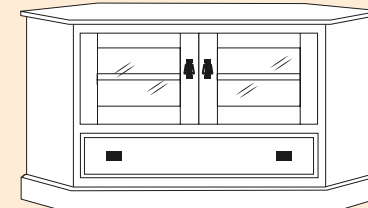

**M5233B-2D ► 52\"w x 33\"h x 18\"d**  
One Drawer on Bottom  
One Adjustable Shelf Behind Doors



## ► Stereo Cabinets

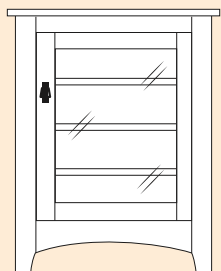

**M2533** ► 25"w x 33"h x 18"d  
Three Adjustable Shelves

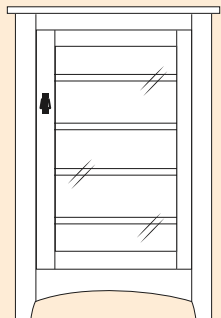

**M2540** ► 25"w x 40"h x 18"d  
Four Adjustable Shelves

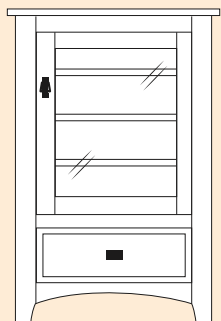

**M2540B** ► 25"w x 40"h x 18"d  
Three Adjustable Shelves and One Drawer

## ► Occasional Furniture



**M103WS** ► Coffee Table  
46"w x 18"h x 22"d  
With Shelf and Drawer



**M104WS** ► End Table  
22"w x 25"h x 22"d  
With Shelf and Drawer



**M105WS** ► Chairside Table  
17"w x 25"h x 22"d  
With Shelf and Drawer



**M106WS** ► Hall Table  
36"w x 30"h x 15"d  
With Shelf and Drawer



**M107WS** ► Sofa Table  
46"w x 30"h x 15"d  
With Shelf and Drawer



**M3** ► Coffee Table  
46"w x 18"h x 22"d



**M4** ► End Table  
20"w x 25"h x 22"d



**M5** ► Chairside End Table  
15"w x 25"h x 22"d



**M6** ► Hall Console  
36"w x 30"h x 14"d



**M108** ► Writing Computer Desk  
36"w x 30"h x 18"d  
With Keyboard Drawer



**M8** ► Mini Secretary Desk  
24"w x 41"h x 14"d



[Not  
Pictured]\*

**53-13** ► Pie Safe  
36"w x 47"h x 16"d

[Not  
Pictured]\*

**52-12** ► Jelly Cupboard  
20"w x 47"h x 16"d



**M1** ► Trash Bin  
20"w x 30"h x 14"d

[Not  
Pictured]\*

**M2** ► Trash Bin  
20"w x 34"h x 14"d  
With Drawer

\*See page 9 for Shaker style of items not pictured here.

# Manchester Furniture



Our line of Manchester furniture features elegant curves and lines, and pewter knobs.

An assortment of stain options is available.

Combine stains for a unique two-tone finish.  
(See page 23)

Many custom options to choose from including:

- Choice of hardware  
(See page 22)
- Wood or glass doors
- Optional pull-out media trays



**Man6625-3D ▶ Television Stand**  
66"w x 25"h x 18"d  
One Adjustable Shelf Behind Each Door  
*Shown in Maple with Michael's Stain*



**Man5233B-2D ▶ Corner Television Stand**  
52"w x 33"h x 18"d  
One Drawer on Bottom, One Adjustable Shelf Behind Doors  
*Shown in Maple with Onyx Stain*



**Man7633-4D ▶ Television Stand**  
76"w x 33"h x 18"d • Two Adjustable Shelves Behind Doors

**Man7646H ▶ Hutch**  
77.5"w x 46"h x 11.75"d  
With One Shelf, Three Shelves Behind Doors  
*Both Shown in Maple with Onyx Stain*



**Man4633B-2D ▶ Television Stand**  
46"w x 33"h x 18"d  
Two Drawers on Bottom • One Adjustable Shelf Behind Doors

**Man4646H ▶ Hutch**  
47.5"w x 46"h x 11.75"d • With One Shelf  
*Both Shown in Maple with Onyx Stain*



**Man4433A-2D ▶ Corner Television Stand**  
44"w x 33"h x 18"d  
6" DVD Opening • One Adjustable Shelf Behind Doors  
*Both Shown in Maple with Mission Maple Stain*



# Manchester Furniture ▶ Television Stands

## 36" Wide TV Stands

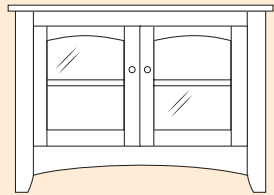

**Man3625-2D** ▶ 36"w x 25"h x 18"d  
One Adjustable Shelf Behind Doors

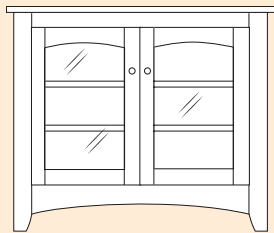

**Man3633-2D** ▶ 36"w x 33"h x 18"d  
Two Adjustable Shelves Behind Doors

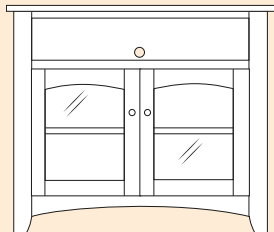

**Man3633A-2D** ▶ 36"w x 33"h x 18"d  
6" DVD Opening • One Adjustable Shelf Behind Doors

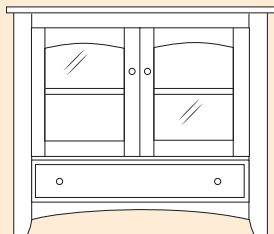

**Man3633B-2D** ▶ 36"w x 33"h x 18"d  
One Drawer on Bottom • One Adjustable Shelf Behind Doors

## 46" Wide TV Stands - 2 Door

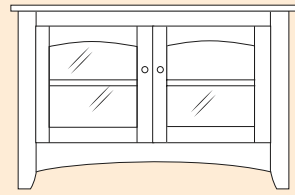

**Man4625-2D** ▶ 46"w x 25"h x 18"d  
One Adjustable Shelf Behind Doors

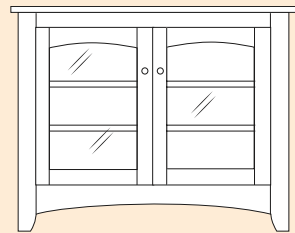

**Man4633-2D** ▶ 46"w x 33"h x 18"d  
Two Adjustable Shelves Behind Doors

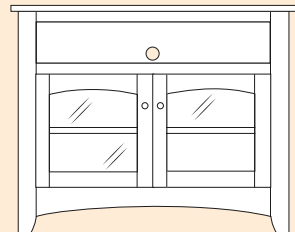

**Man4633A-2D** ▶ 46"w x 33"h x 18"d  
6" DVD Opening • One Adjustable Shelf Behind Doors

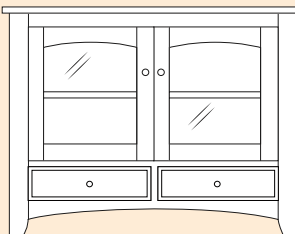

**Man4633B-2D** ▶ 46"w x 33"h x 18"d  
Two Drawers on Bottom • One Adjustable Shelf Behind Doors

## 46" Wide TV Stands - 3 Door



**Man4625-3D** ▶ 46"w x 25"h x 18"d  
One Adjustable Shelf Behind Doors

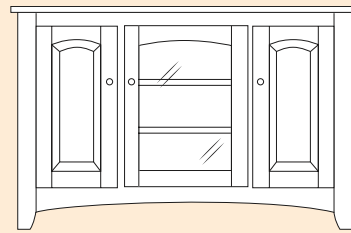

**Man4633-3D** ▶ 46"w x 33"h x 18"d  
Two Adjustable Shelves Behind Doors

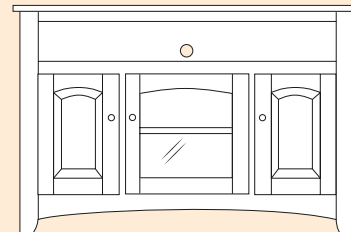

**Man4633A-3D** ▶ 46"w x 33"h x 18"d  
6" DVD Opening • One Adjustable Shelf Behind Doors

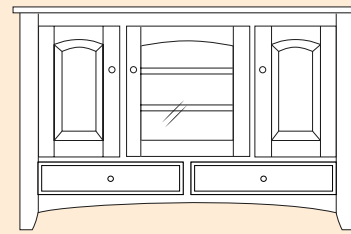

**Man4633B-3D** ▶ 46"w x 33"h x 18"d  
Two Drawers on Bottom  
Two Adjustable Shelves Behind Center Door  
One Adjustable Shelf Behind Side Doors

## 56" Wide TV Stands

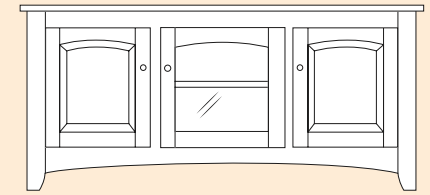

**Man5625-3D** ▶ 56"w x 25"h x 18"d  
One Adjustable Shelf Behind Doors

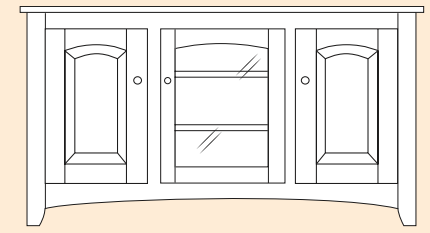

**Man5633-3D** ▶ 56"w x 33"h x 18"d  
Two Adjustable Shelves Behind Doors

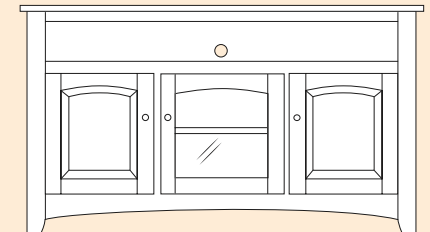

**Man5633A-3D** ▶ 56"w x 33"h x 18"d  
6" DVD Opening • One Adjustable Shelf Behind Doors

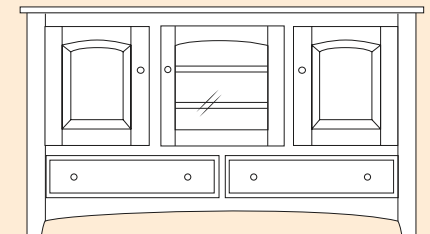

**Man5633B-3D** ▶ 56"w x 33"h x 18"d  
Two Drawers on Bottom  
Two Adjustable Shelves Behind Center Door  
One Adjustable Shelf Behind Side Doors

# Manchester Furniture ▶ Television Stands

## 66" Wide TV Stands

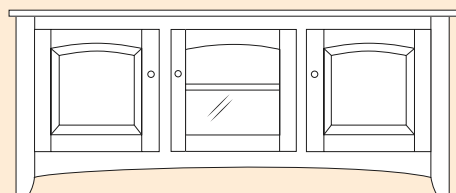

**Man6625-3D** ▶ 66"w x 25"h x 18"d  
One Adjustable Shelf Behind Doors

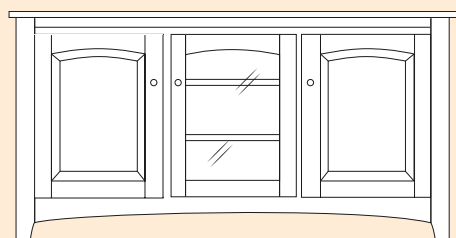

**Man6633-3D** ▶ 66"w x 33"h x 18"d  
Two Adjustable Shelves Behind Doors

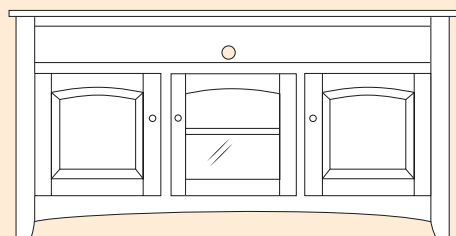

**Man6633A-3D** ▶ 66"w x 33"h x 18"d  
6" DVD Opening • One Adjustable Shelf Behind Doors

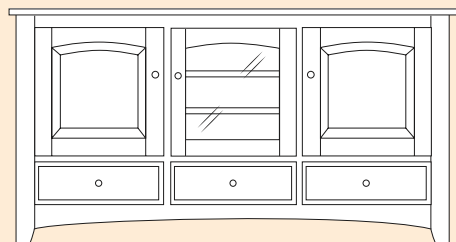

**Man6633B-3D** ▶ 66"w x 33"h x 18"d  
Three Drawers on Bottom  
Two Adjustable Shelves Behind Center Door  
One Adjustable Shelf Behind Side Doors

## 76" Wide TV Stand

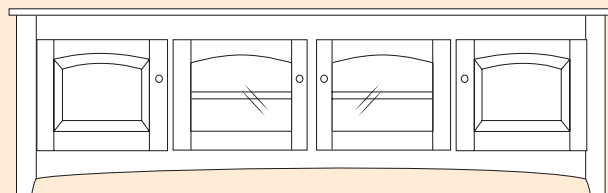

**Man7625-4D** ▶ 76"w x 25"h x 18"d  
One Adjustable Shelf Behind Doors

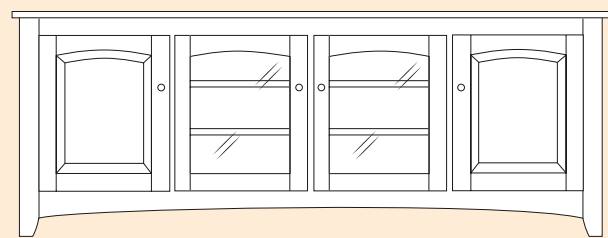

**Man7633-4D** ▶ 76"w x 33"h x 18"d  
Two Adjustable Shelves Behind Doors

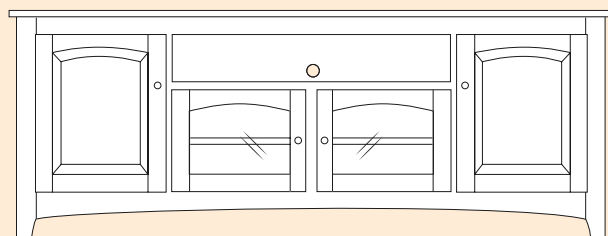

**ManS7633A-4D** ▶ 76"w x 33"h x 18"d  
6" DVD Opening • One Adjustable Shelf Behind Center Doors  
Two Adjustable Shelves Behind Side Doors

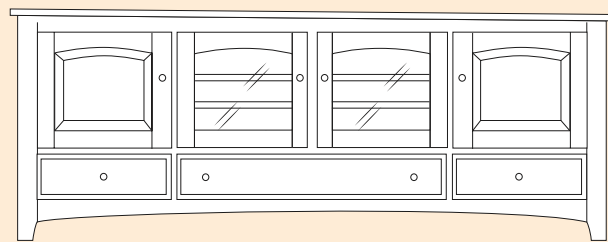

**Man7633B-4D** ▶ 76"w x 33"h x 18"d  
Three Drawers on Bottom  
Two Adjustable Shelves Behind Center Doors  
One Adjustable Shelf Behind Side Doors

# ▶ Hutches

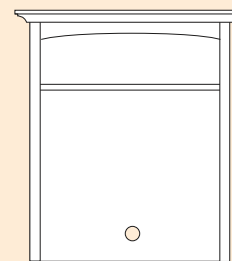

**Man3646H** ▶ 37.5"w x 46"h x 11.75"d  
With One Shelf

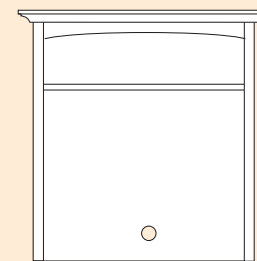

**Man4646H** ▶ 47.5"w x 46"h x 11.75"d  
With One Shelf

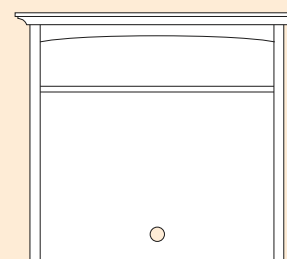

**Man5646H** ▶ 57.5"w x 46"h x 11.75"d  
With One Shelf

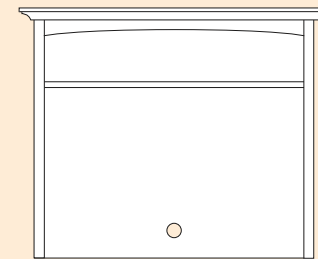

**Man6646H** ▶ 67.5"w x 46"h x 11.75"d  
With One Shelf

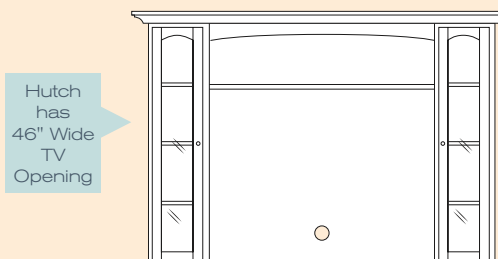

**Man7646H** ▶ 77.5"w x 46"h x 11.75"d  
With One Shelf and 2 Doors • Three Shelves Behind Doors

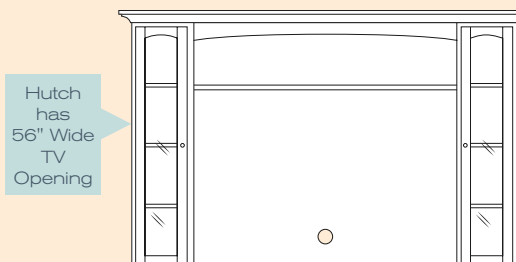

**Man8646H** ▶ 87.5"w x 46"h x 11.75"d  
With One Shelf and 2 Doors • Three Shelves Behind Doors

# Manchester Furniture

## ► Entertainment Center

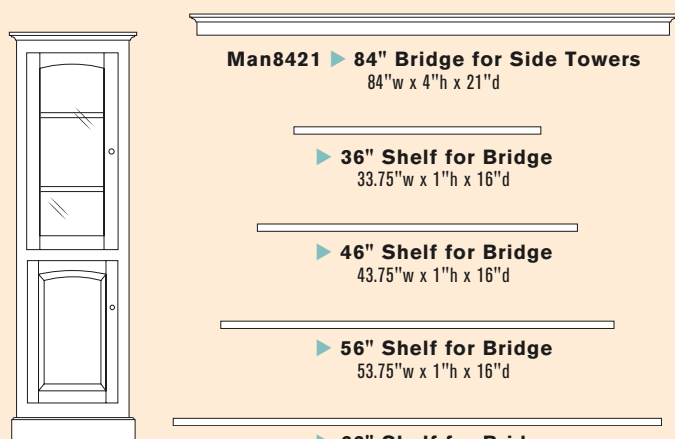
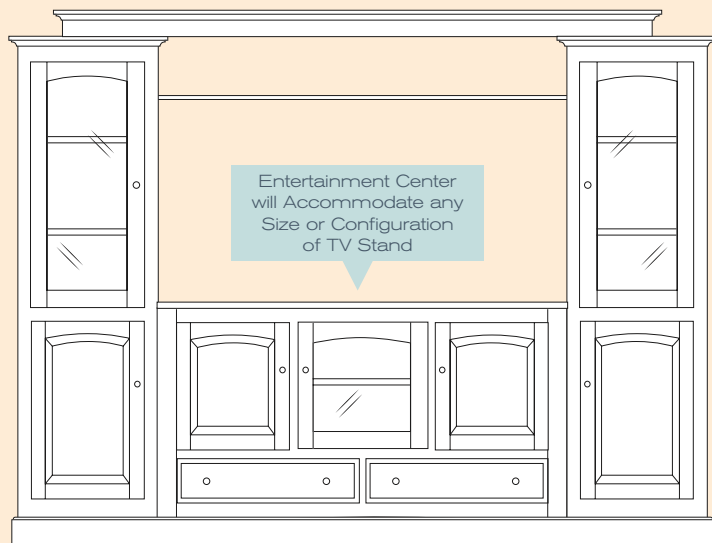

**Man2464T ► 64" Tower**  
24.25"w x 64"h x 18.625"d  
One Adjustable Shelf Behind Wood Door on Bottom, Two Adjustable Shelves Behind Glass Door on Top

**Man2472T ► 72" Tower**  
24.25"w x 72"h x 18.625"d  
Two Adjustable Shelves Behind Wood Door on Bottom, Two Adjustable Shelves Behind Glass Door on Top

### Dimensions for Corner TV Stands

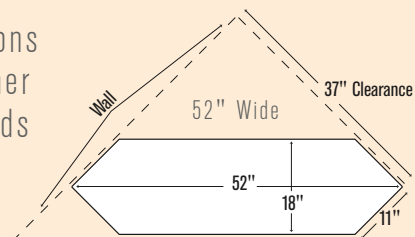
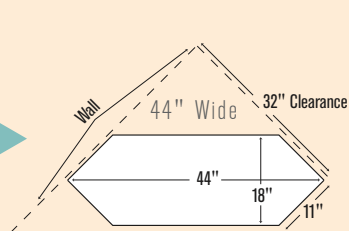

## ► Corner Television Stands

### 44" Wide Corner TV Stands

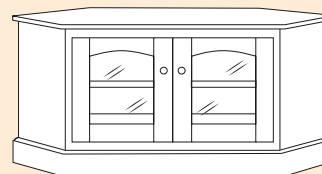

**Man4425-2D ► 44"w x 25"h x 18"d**  
One Adjustable Shelf Behind Doors

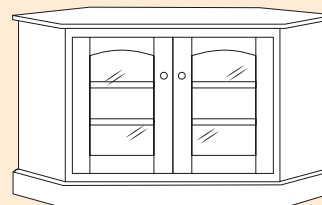

**Man4433-2D ► 44"w x 33"h x 18"d**  
Two Adjustable Shelves Behind Doors

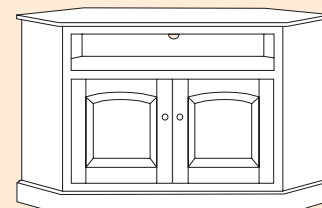

**Man4433A-2D ► 44"w x 33"h x 18"d**  
6" DVD Opening • One Adjustable Shelf Behind Doors

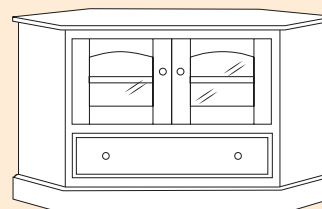

**Man4433B-2D ► 44"w x 33"h x 18"d**  
One Drawer on Bottom  
One Adjustable Shelf Behind Doors

### 52" Wide Corner TV Stands

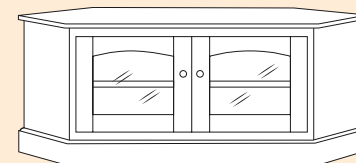

**Man5225-2D ► 52"w x 25"h x 18"d**  
One Adjustable Shelf Behind Doors

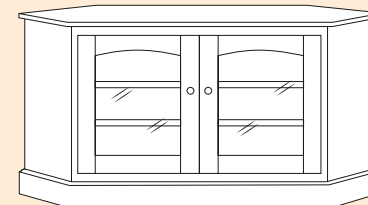

**Man5233-2D ► 52"w x 33"h x 18"d**  
Two Adjustable Shelves Behind Doors

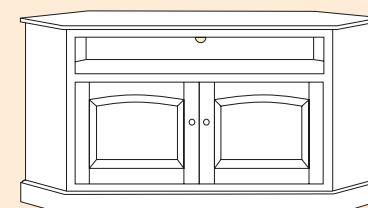

**Man5233A-2D ► 52"w x 33"h x 18"d**  
6" DVD Opening • One Adjustable Shelf Behind Doors

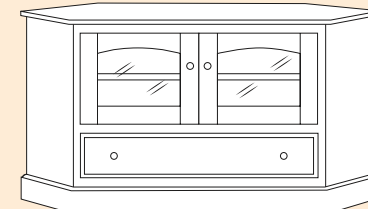

**Man5233B-2D ► 52"w x 33"h x 18"d**  
One Drawer on Bottom  
One Adjustable Shelf Behind Doors

## ► Stereo Cabinets

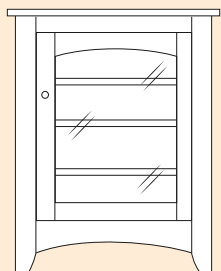

**Man2533** ► 25"w x 33"h x 18"d  
Three Adjustable Shelves

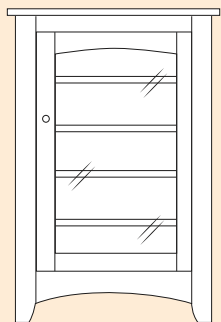

**Man2540** ► 25"w x 40"h x 18"d  
Four Adjustable Shelves

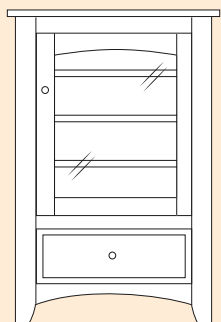

**Man2540B** ► 25"w x 40"h x 18"d  
Three Adjustable Shelves and One Drawer

## ► Occasional Furniture



**Man103WS** ► Coffee Table  
46"w x 18"h x 22"d  
With Shelf and Drawer



**Man3** ► Coffee Table  
46"w x 18"h x 22"d



**Man108** ► Writing Computer Desk  
36"w x 30"h x 18"d  
With Keyboard Drawer



[Not Pictured]\*

**Man8** ► Mini Secretary Desk  
24"w x 41"h x 14"d



**Man104WS** ► End Table  
22"w x 25"h x 22"d  
With Shelf and Drawer



**Man4** ► End Table  
20"w x 25"h x 22"d

[Not Pictured]\*

**Man1** ► Trash Bin  
20"w x 30"h x 14"d

[Not Pictured]\*

**Man2** ► Trash Bin  
20"w x 34"h x 14"d  
With Drawer



**Man105WS** ► Chairside Table  
17"w x 25"h x 22"d  
With Shelf and Drawer



**Man5** ► Chairside End Table  
15"w x 25"h x 22"d

[Not Pictured]\*

**Man13** ► Pie Safe  
36"w x 47"h x 16"d



**Man106WS** ► Hall Table  
36"w x 30"h x 15"d  
With Shelf and Drawer



**Man6** ► Hall Console  
36"w x 30"h x 14"d



**Man107WS** ► Sofa Table  
46"w x 30"h x 15"d  
With Shelf and Drawer



**Man11** ► Microwave Stand  
30"w x 36"h x 18"d



**Man12** ► Jelly Cupboard  
20"w x 47"h x 16"d



Unique combination of a  
Man11 Microwave Stand with  
Hutch for extra storage!

\*See page 9 for Shaker style of items not pictured here.



# Hardware Options



Shaker comes with wood Shaker knobs  
Mission comes with black mission hardware  
Manchester comes with satin nickel knobs

We offer a variety of custom choices, including:

- ▶ Choice of hardware
- ▶ Choice of glass or wood doors
- ▶ Optional pull-out media trays



#1 #11 #14 #15



#7



#3B



#16 #12 #13



#5



#9



#23



#25



#33 #35 #29 #31



#38



#27



#28



#34



#10 #24 #26



#19



#17



#32



#37



#2B



#4



#6



#8



#30



#36

# Stain Options



Stain color may vary slightly from piece to piece and from shown.

## ▶ Oak Stains



## ▶ Cherry Stains



## ▶ Brown Maple Stains\*



\*For customers seeking a lighter stain on maple wood, clear maple is recommended.

# Paint Options

Paint color may vary slightly from shown.



# Distressing Options

Add a patina of age without harming the structural integrity of your furniture.



Rub Through Finish



Rub Through Finish Detail

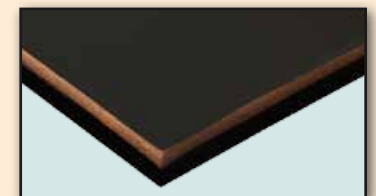

Black Paint with Harvest Stain Rub Through

Authorized Dealer 